



# La *P*lage

Camping - Club



MIMIZAN PLAGES - LANDES



# Landes, a destination



## WELCOME TO OUR DEPARTMENT

The Landes don't only offer 106 km of beautiful sandy beaches...

It offers diversity between coastline, forests, lakes, natural reserves and an amazing countryside...

Located between Spain and the wine-growing region of Bordeaux, this land is inviting you to discover it, and you won't be disappointed!



## THE LANDES DE GASCOGNE REGIONAL NATURAL PARK



## CLIMB ONTO YOUR BIKE...

The Landes will become your favourite playground! 550 km of cycle paths are available to you!

# ion of many facets



## OUR SPECIALITY? GOOD FOOD...

Consume our local  
"made in Landes"  
products to your heart's content!



## A UNIQUE EXPERIENCE...

If you want to find out what life was  
like in the Landes de Gascogne in 1890,  
visit the Ecomuseum of Marquèze and  
its recreated 19th century village.



## ATLANTIC-PARK

One hour from the campsite in Seignosse,  
ATLANTIC-PARK is the biggest water park  
in the Landes, designed for a whole day of  
family fun. 2800m<sup>2</sup> of pools heated to 27°C.  
Ask for discounted tickets at the campsite  
reception! ([www.atlantic-park.com](http://www.atlantic-park.com))

# Mimizan



## THE BEACH

When you bring your little group to the beaches of Mimizan you only want one thing: to make sure everyone has fun.

The distinctive feature of our beaches are the immense and protective dunes, and, at the end, our beaches.

Here, we combine leisure, water sports and beach games.



## SURFING

Don't try to tell us that the best surfing is on the Basque Coast!

Oh, no, the most famous spots are in the Landes!

Mimizan, the "Pearl of the Silver Coast", has a strategic position between the beaches and surf spots of the Gironde and the southern beaches of the Landes.



## THE GREAT LAKES REGION...

The Landes is full of surprises... The huge expanses of water bordered by pines and beautiful sandy beaches, are among the largest freshwater lakes in France.

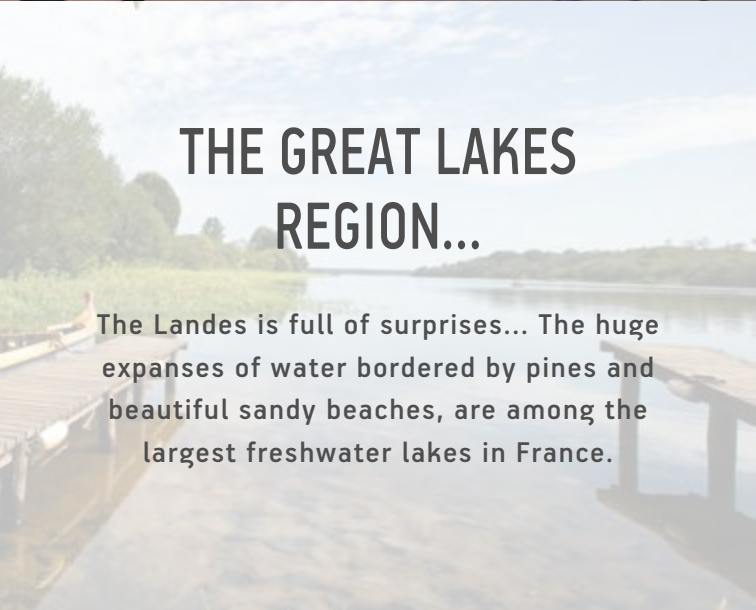

is also...



## VISITS AND DISCOVERIES...

For art and history lovers, a visit to Mimizan Bourg is essential. Located on the Camino de Santiago, the town of Mimizan is home to a magnificent bell tower which was once used as a lighthouse for fishermen. The "Musée du Prieuré" houses jewels of medieval art.



## GOLF

Did you know that in the Landes, golf courses are designed on sandy soils, which allows you to play all year round!

The golf course in Mimizan is located between the lake and the ocean and offers a 9-hole course ideal for both beginners and advanced golfers.



## FISHING...

In Mimizan, you can go fishing all year round! Contests, beginners courses and surf fishing along our coast, as well as freshwater fishing.

# A campsite m

## WATER AREA

Chop and change between our indoor and outdoor aquatic areas! The heated indoor area with a jacuzzi is great for relaxing, while the outdoor area will suit the more energetic!



## WELL-BEING AREA

Both cosy and friendly, everything is designed to offer a warm and casual break from the stress of life. Discover our well-being area for massages, treatments, jacuzzi, hammam and sauna: your holiday starts here...

*In July and August*

# ade for you...

## FOR CHILDREN...

The Kids Club, for children aged between 4 and 12, is completely free and will keep your children occupied all day long!

Qualified organisers will introduce your children to treasure hunts and team sports, as well as artistic and other recreational activities!

Everything they need to laugh and let off steam as they play and learn. And make lots of friends!

*In July and August*



## ENTERTAINMENT

Get ready for a summer of excitement with our animation team who will help you to get back in shape as well as sharing moments of togetherness. Evening entertainment to make your holidays unforgettable: cabaret, magic, hypnosis, dance evenings, team show.

*In July and August*

# The little extras m



## DURING THE DAY...

Here you aren't forced to do anything,  
you choose...

In our campsite, you will find a  
restaurant/snack bar, a sports hall, a  
multi-sport field, a bowls court,  
a mini-golf course, table tennis tables,  
a children's playground and a  
laundry room.





ake a difference...



## EVEN MORE FACILITIES...

Because we put so much emphasis on your enjoyment, in peak season you will find:  
bike rentals and many external service providers who will offer you a variety of activities.

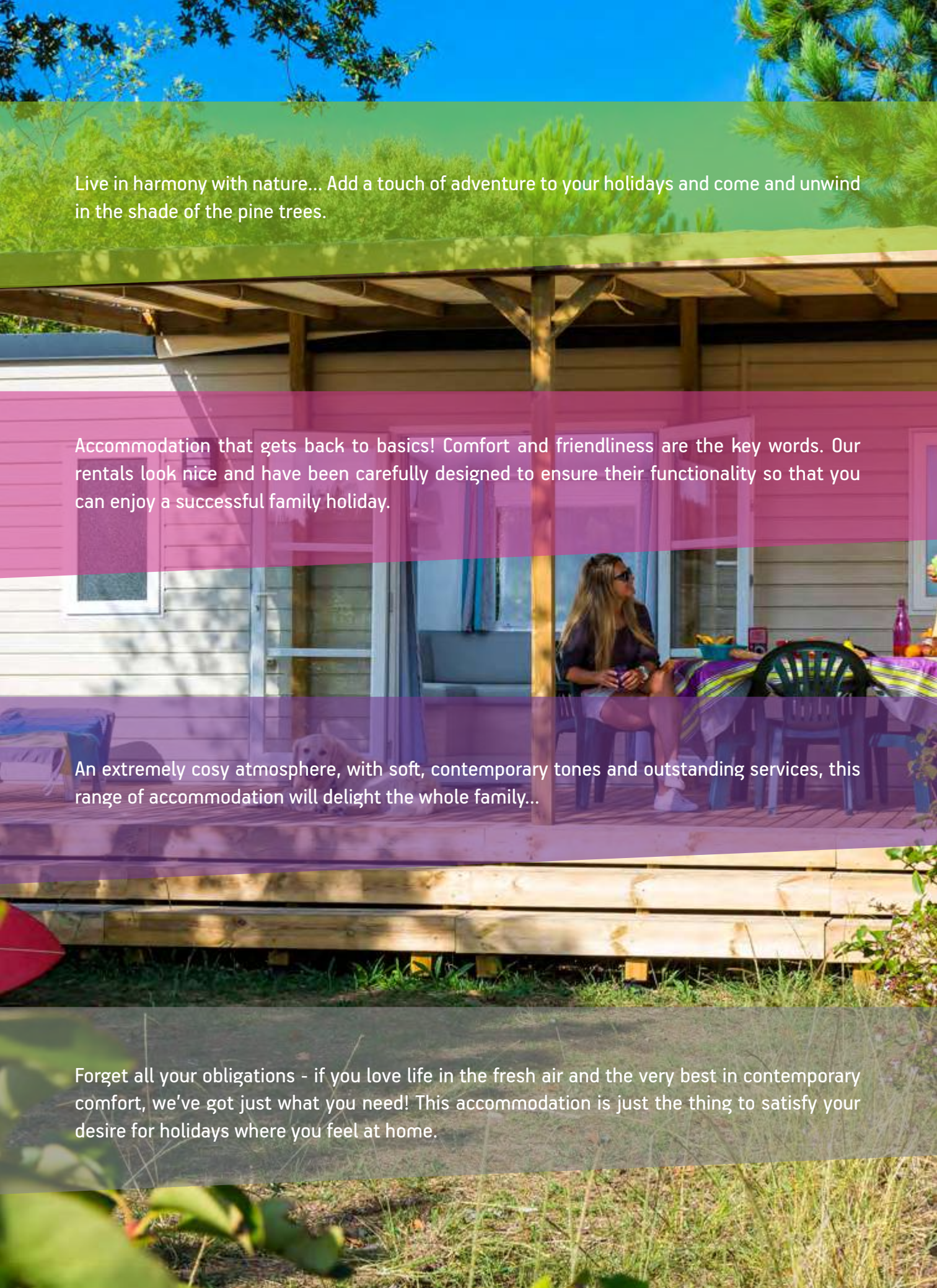

A woman with long blonde hair and sunglasses is sitting on a wooden deck in front of a cabin. The cabin has light-colored horizontal siding and a wooden pergola structure over the deck. There are several tables and chairs on the deck, some with colorful tablecloths. The background is filled with lush green pine trees under a clear blue sky. The scene is bright and sunny, suggesting a warm day.

Live in harmony with nature... Add a touch of adventure to your holidays and come and unwind in the shade of the pine trees.

Accommodation that gets back to basics! Comfort and friendliness are the key words. Our rentals look nice and have been carefully designed to ensure their functionality so that you can enjoy a successful family holiday.

An extremely cosy atmosphere, with soft, contemporary tones and outstanding services, this range of accommodation will delight the whole family...

Forget all your obligations - if you love life in the fresh air and the very best in contemporary comfort, we've got just what you need! This accommodation is just the thing to satisfy your desire for holidays where you feel at home.



# Nature Range

Live in harmony with nature...

# Comfort Range

Nice, simple holidays...

# Comfort Plus Range

If you want those little extras...

# Prestige Range

You can't go wrong...

O  
U  
R  
  
R  
A  
N  
G  
E  
S

# Booking smart !

## Your Holidays 2022

### Our special offers

**-25% & -30%**

-25 % discount on any stay of 7 consecutive nights\* in rental accommodation

30% discount on any stay of 14 consecutive nights\* in rental accommodation

\*valid from 08/04/2022 to 02/07/2022 and from 28/08/2022 to 24/09/2022

### Reservation fees offers

For any online reservation

## Nature Range

### Campsite rates from 08/04 to 24/09/2022 (Open arrival and departure dates)

| Rates per night<br>6 pers. max. (babies included)  | OFF-SEASON<br>From 08/04<br>to 10/06 | LOW SEASON<br>From 11/06<br>to 01/07 | HIGH SEASON<br>From 02/07<br>to 15/07 | HIGH SEASON<br>From 16/07<br>to 19/08 | HIGH SEASON<br>From 20/08<br>to 26/08 | LOW SEASON<br>From 27/08<br>to 09/09 | OFF-SEASON<br>From 10/09<br>to 24/09 |
|--|--------------------------------------|--------------------------------------|---------------------------------------|---------------------------------------|---------------------------------------|--------------------------------------|--------------------------------------|
| 1 or 2 pers. package<br>- Tent or caravan + car<br>- or camper van<br>- or fitted van<br>- + electricity | 22 €                                 | 28 €                                 | 43 €                                  | 50 €                                  | 34 €                                  | 25 €                                 | 22 €                                 |
| Additional adult (+ 18 years)  | 7 €                                  | 7 €                                  | 10 €                                  | 12 €                                  | 9 €                                   | 7 €                                  | 7 €                                  |
| Additional child (2 to 17 years)   | 5 €                                  | 5 €                                  | 8 €                                   | 10 €                                  | 6 €                                   | 5 €                                  | 5 €                                  |
| Fridge hire (subject to availability)  | 6 €                                  | 6 €                                  | 6 €                                   | 8 €                                   | 8 €                                   | 6 €                                  | 6 €                                  |
| Additional tent  | 4 €                                  | 5 €                                  | 5 €                                   | 5 €                                   | 5 €                                   | 5 €                                  | 4 €                                  |
| Additional car<br>(on request, subject to availability)  | -                                    | 5 €                                  | 5 €                                   | 5 €                                   | 5 €                                   | -                                    | -                                    |
| Pet (on a leash)   | -                                    | 5 €                                  | 5 €                                   | 5 €                                   | 5 €                                   | -                                    | -                                    |

- Reservations can be made for a minimum of 2 nights in the off-season and low-season, and for minimum 7 nights in the high season.
- Children under 2 years at the time stay for free.
- Pets allowed: 1 pet per campsite, those classed as category 1 or 2 are prohibited.
- For an electricity connection, please provide your own adaptor for a European socket, and an extension cord.
- Additional booking fee: €20 for all reservations for a stay of more than 2 nights, €10 for all weekend stays (2 nights) and FREE for all online reservations via our website.
- One vehicle per campsite, a second vehicle may be accepted depending on the dates of your stay by special request to the campground, and for an additional fee.

# Nature Range

View the  
'book smart'  
page

## Ti Lodge - 2 people - 13 m<sup>2</sup> Accommodation **without sanitary facilities** or **water supply**

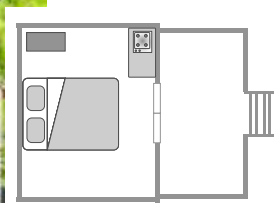

Age of rental: 9 years

### Description:

- bedroom n°1: 1 double bed 140 x 190
- 1 kitchenette (refrigerator, hotplate, crockery and kitchen utensils, electric coffee maker, microwave oven)

All our rentals are equipped with duvets and pillows - Non-contractual photos and plans

### RATES PER NIGHT

| From 10/06 to 24/06 | From 25/06 to 01/07 | From 02/07 to 08/07  | From 09/07 to 22/07 | From 23/07 to 29/07 | From 30/07 to 12/08 | From 13/08 to 19/08 | From 20/08 to 26/08 | From 27/08 to 16/09 |
|---------------------|---------------------|--|---------------------|---------------------|---------------------|---------------------|---------------------|---------------------|
| 35 €                | 45 €                | 60 €   | 85 €                | 90 €                | 95 €                | 80 €                | 60 €                | 35 €                |
| Minimum 2 nights    |                     | Week-long stays only - Possible days of arrival: SATURDAY (Arrival: 4pm - Departure: 7am-10am) |                     |                     |                     |                     | Minimum 2 nights    |                     |

## Lodge - 4 people - 23 m<sup>2</sup> Accommodation **without sanitary facilities** or **water supply**



Age of rental: 9 years

### Description:

- bedroom n°1: 1 double bed 140 x 190
- bedroom n°2: 2 single beds 70 x 190
- 1 kitchenette (refrigerator, hotplate, crockery and kitchen utensils, electric coffee maker, microwave oven)

All our rentals are equipped with duvets and pillows - Non-contractual photos and plans

### RATES PER NIGHT

| From 10/06 to 24/06 | From 25/06 to 01/07 | From 02/07 to 08/07  | From 09/07 to 22/07 | From 23/07 to 12/08 | From 13/08 to 19/08 | From 20/08 to 26/08 | From 27/08 to 16/09 |
|---------------------|---------------------|--|---------------------|---------------------|---------------------|---------------------|---------------------|
| 40 €                | 55 €                | 80 €   | 105 €               | 115 €               | 100 €               | 70 €                | 40 €                |
| Minimum 2 nights    |                     | Week-long stays only - Possible days of arrival: SATURDAY (Arrival: 4pm - Departure: 7am-10am) |                     |                     |                     |                     | Minimum 2 nights    |

## Safari Lodge - 4/5 people - 34,50 m<sup>2</sup> Accommodation **without sanitary facilities** or **water supply**



Age of rental: 4 years

### Description:

- bedroom n°1: 1 double bed 140 x 190
- bedroom n°2: 1 double bed 140 x 190 and 1 single raised bed 90 x 190
- 1 kitchenette (refrigerator, hotplate, crockery and kitchen utensils, electric coffee maker, microwave oven)
- Integrated covered terrace 11,50 m<sup>2</sup>

All our rentals are equipped with duvets and pillows - Non-contractual photos and plans

### RATES PER NIGHT

| From 10/06 to 24/06 | From 25/06 to 01/07 | From 02/07 to 08/07  | From 09/07 to 22/07 | From 23/07 to 12/08 | From 13/08 to 19/08 | From 20/08 to 26/08 | From 27/08 to 16/09 |
|---------------------|---------------------|--|---------------------|---------------------|---------------------|---------------------|---------------------|
| 45 €                | 65 €                | 90 €   | 115 €               | 125 €               | 105 €               | 85 €                | 45 €                |
| Minimum 2 nights    |                     | Week-long stays only - Possible days of arrival: SATURDAY or SUNDAY (Arrival: 4pm - Departure: 7am-10am) |                     |                     |                     |                     | Minimum 2 nights    |

# Comfort Range

*Between the Mobile Home and*



## Mobil home Comfort 2 bed. disabled access- 4 people- 32m<sup>2</sup> suitable for persons with a disability



Age of rental: 13 years

### Description:



- bedroom n°1: 2 single beds 90 x 190
- bedroom n°2: 2 single beds 70 x 190 (including 1 raised bed for children aged over 6 only)
- 1 kitchenette (refrigerator, hotplate, extractor hood, crockery and kitchen utensils, electric coffee maker, microwave oven)
- 1 shower room + toilet
- 1 covered terrace: 18 m<sup>2</sup> with access ramp

All our rentals are equipped with duvets and pillows - Non-contractual photos and plans

### RATES PER NIGHT

| From 08/04 to 24/06 | From 25/06 to 01/07 | From 02/07 to 08/07  | From 09/07 to 15/07 | From 16/07 to 22/07 | From 23/07 to 29/07 | From 30/07 to 12/08 | From 13/08 to 19/08 | From 20/08 to 26/08 | From 27/08 to 24/09 |
|---------------------|---------------------|--|---------------------|---------------------|---------------------|---------------------|---------------------|---------------------|---------------------|
| 60 €                | 80 €                | 105 €  | 135 €               | 140 €               | 155 €               | 190 €               | 150 €               | 115 €               | 60 €                |
| Minimum 2 nights    |                     | Week-long stays only - Possible days of arrival: SATURDAY (Arrival: 4pm - Departure: 7am-10am) |                     |                     |                     |                     |                     | Minimum 2 nights    |                     |

## Mobil home Comfort 3 bed. - 6 people - 32 m<sup>2</sup>



Age of rental: from 7 to 12 years

### Description:

- bedroom n°1: 1 double bed 140 x 190
- bedroom n°2: 2 single beds 70 x 190
- bedroom n°3: 2 single beds 70 x 190
- 1 kitchenette (refrigerator, hotplate, extractor hood, crockery and kitchen utensils, electric coffee maker, microwave oven)
- 1 shower room + separate toilet
- 1 covered terrace: 18 m<sup>2</sup>

All our rentals are equipped with duvets and pillows - Non-contractual photos and plans

### RATES PER NIGHT

| From 08/04 to 24/06 | From 25/06 to 01/07 | From 02/07 to 08/07  | From 09/07 to 15/07 | From 16/07 to 22/07 | From 23/07 to 29/07 | From 30/07 to 12/08 | From 13/08 to 19/08 | From 20/08 to 26/08 | From 27/08 to 09/09 | From 10/08 to 24/09 |
|---------------------|---------------------|--|---------------------|---------------------|---------------------|---------------------|---------------------|---------------------|---------------------|---------------------|
| 60 €                | 80 €                | 110 €  | 130 €               | 140 €               | 155 €               | 185 €               | 135 €               | 115 €               | 65 €                | 60 €                |
| Minimum 2 nights    |                     | Week-long stays only - Possible days of arrival: SATURDAY OR SUNDAY (Arrival: 4pm - Departure: 7am-10am) |                     |                     |                     |                     |                     | Minimum 2 nights    |                     |                     |

### Cottage Comfort 2 bed. - 4 people - 27 m<sup>2</sup>



Age of rental: from 1 to 5 years

#### Description:

- bedroom n°1: 1 double bed 140 x 190
- bedroom n°2: 2 single beds 70 x 190
- 1 living area
- 1 kitchenette (refrigerator, hotplate, extractor hood,
- crockery and kitchen utensils, electric coffee maker, microwave oven)
- 1 shower room + separate toilet
- 1 covered terrace: 13,50 m<sup>2</sup>

All our rentals are equipped with duvets and pillows - Non-contractual photos and plans

#### RATES PER NIGHT

|                     |                     |  |                     |                     |                     |                     |                     |                     |                     |
|---------------------|---------------------|--|---------------------|---------------------|---------------------|---------------------|---------------------|---------------------|---------------------|
| From 08/04 to 24/06 | From 25/06 to 01/07 | From 02/07 to 08/07  | From 09/07 to 15/07 | From 16/07 to 22/07 | From 23/07 to 29/07 | From 30/07 to 12/08 | From 13/08 to 19/08 | From 20/08 to 26/08 | From 27/08 to 24/09 |
| 60 €                | 80 €                | 105 €  | 130 €               | 140 €               | 150 €               | 180 €               | 145 €               | 115 €               | 60 €                |
| Minimum 2 nights    |                     | Week-long stays only - Possible days of arrival: SATURDAY (Arrival: 4pm - Departure: 7am-10am) |                     |                     |                     |                     |                     | Minimum 2 nights    |                     |

### Cottage Comfort 3 bed. - 6 people - 32 m<sup>2</sup>

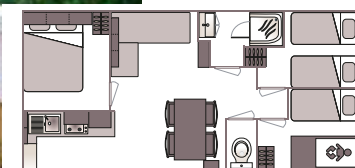

Age of rental: 4 years

#### Description:

- bedroom n°1: 1 double bed 140 x 190
- bedroom n°2: 2 single beds 70 x 190
- bedroom n°3: 2 single beds 70 x 190
- 1 kitchenette (refrigerator,
- hotplate, extractor hood, crockery and kitchen utensils, electric coffee maker, microwave oven)
- 1 shower room + separate toilet
- 1 covered terrace: 18 m<sup>2</sup>

All our rentals are equipped with duvets and pillows - Non-contractual photos and plans

#### RATES PER NIGHT

|                     |                     |  |                     |                     |                     |                     |                     |                     |                     |                     |
|---------------------|---------------------|--|---------------------|---------------------|---------------------|---------------------|---------------------|---------------------|---------------------|---------------------|
| From 08/04 to 24/06 | From 25/06 to 01/07 | From 02/07 to 08/07  | From 09/07 to 15/07 | From 16/07 to 22/07 | From 23/07 to 29/07 | From 30/07 to 12/08 | From 13/08 to 19/08 | From 20/08 to 26/08 | From 27/08 to 09/09 | From 10/08 to 24/09 |
| 75 €                | 90 €                | 120 €  | 150 €               | 160 €               | 170 €               | 200 €               | 175 €               | 135 €               | 70 €                | 65 €                |
| Minimum 2 nights    |                     | Week-long stays only - Possible days of arrival: SATURDAY OR SUNDAY (Arrival: 4pm - Departure: 7am-10am) |                     |                     |                     |                     |                     | Minimum 2 nights    |                     |                     |



# Comfort Plus Range

View the  
'book smart'  
page

Chalet Comfort Plus 2 bed. - 4 people - 34m<sup>2</sup>



Age of rental:  
21 years renovated

## Description:

- bedroom n°1: 1 double bed 140 x 190
- bedroom n°2: 2 single beds 80 x 190
- 1 kitchenette (refrigerator, dishwasher, hotplate, extractor hood, crockery and kitchen utensils, electric coffee maker, microwave)
- television
- 1 shower room + separate toilet
- 1 covered terrace: 10m<sup>2</sup>
- some models have a uncovered 20m<sup>2</sup> terrace (upon request)

All our rentals are equipped with duvets and pillows - Non-contractual photos and plans

## RATES PER NIGHT

| From 08/04 to 24/06 | From 25/06 to 01/07 | From 02/07 to 08/07  | From 09/07 to 22/07 | From 23/07 to 29/07 | From 30/07 to 12/08 | From 13/08 to 19/08 | From 20/08 to 26/08 | From 27/08 to 24/09 |  |
|---------------------|---------------------|--|---------------------|---------------------|---------------------|---------------------|---------------------|---------------------|--|
| 75 €                | 90 €                | 120 €  | 150 €               | 180 €               | 210 €               | 160 €               | 130 €               | 70 €                |  |
| Minimum 2 nights    |                     | Week-long stays only - Possible days of arrival: SATURDAY or SUNDAY (Arrival: 4pm - Departure: 7am-10am) |                     |                     |                     |                     |                     | Minimum 2 nights    |  |





# Prestige Range

View the  
'book smart'  
page



## Cottage Prestige 3 bed. - 6 people - 35 m<sup>2</sup>



### Description:

- Bedroom n°1: 1 double bed (140 x 190cm), with a shower room and toilet
- Bedroom n°2: 2 single beds (80x190cm)
- Bedroom n°3: 2 single beds (70x190cm)
- 1 kitchenette (dishwasher, fridge-freezer, hob, extractor hood, crockery and kitchen utensils, electric coffee maker, kettle, toaster, microwave)
- 1 shower room + separate toilet
- Hair dryer
- Air-conditioning
- Television
- 2 Deckchairs
- Plancha griddle
- Covered terrace



Age of rental: 4 years

All our rentals are equipped with duvets and pillows - Non-contractual photos and plans

### RATES PER NIGHT

| From 08/04 to 24/06 | From 25/06 to 01/07 | From 02/07 to 08/07 | From 09/07 to 15/07 | From 16/07 to 22/07 | From 23/07 to 29/07 | From 30/07 to 12/08 | From 13/08 to 19/08 | From 20/08 to 26/08 | From 27/08 to 24/09 |
|---------------------|---------------------|---------------------|---------------------|---------------------|---------------------|---------------------|---------------------|---------------------|---------------------|
| 100 €               | 125 €               | 165 €               | 190 €               | 195 €               | 220 €               | 250 €               | 210 €               | 150 €               | 100 €               |

Minimum 2 nights

Week-long stays only - Possible days of arrival: SATURDAY (Arrival: 4pm - Departure: 7am-10am)

Minimum 2 nights

## I/ CONDITIONS OF RESERVATION

All reservation requests must be accompanied by the payment of a deposit and booking fee, as well as an acceptance of the general terms of sale. The reservation will be considered finalised as soon as it has received written approval from Camping de la Plage. Minors must be accompanied by their parents or legal guardians. Camping de la Plage offers holidays intended for families, it thus reserves the right to refuse any reservation that would go against or stray from this principle. As the reservation of a campsite or accommodation is nominative, it is not to be sublet or sold. In the case of an incorrect declaration by the customer, the present contract will be rightfully terminated and the sums paid retained by the manager.

## II/ CONDITIONS OF PAYMENT

### 1- Administrative Fee:

This can be up to €20 for the week for a paper application, €10 for weekends and **free for all online reservations** via our website [www.destinationmimizan.com](http://www.destinationmimizan.com). In the event of a cancellation (excluding applications with a specific cancellation insurance), this payment will not be reimbursed.

### 2- Deposit / Balance:

- If the reservation takes place more than 30 days before the date of the stay, a deposit of 30% of the total cost of the stay + an administrative fee will be required, and the remaining balance must be paid 30 days before the starting date of your stay, at the latest.

- If the reservation takes place less than 30 days before the start of your stay, you must pay the total cost of your stay upon reservation.

### 3- Tourist tax:

The prices displayed per night now include the tourist tax.

## III/ YOUR STAY

### 1- Campsite Arrivals

Upon your arrival, we will ask you for a security deposit of €20 for the entry pass to the campground gate. This deposit will be reimbursed at the end of the stay in exchange for the entry pass. Each of you will be provided with an access wristband **(the wearing of which is mandatory)** for which you will be charged €5 in the event of it being lost. Off-season: you may arrive on the day of your choice for a stay of minimum 2 nights. The rented campsite will be made available to you from 2pm to 6pm. In July-August: you may arrive on your date of choice for a stay of minimum one week. The campsite will be made available to you from 2pm to 8pm. You must inform the campground of any late arrival. The campsite is reserved for 24 hours following the planned date of your arrival. After that time, it will no longer be reserved and you will be required to pay the total cost of your stay. One vehicle per campsite, a second vehicle may be accepted depending on the dates of your stay by special request to the campground, and for an additional fee (see rates).

### 2- Rental Arrivals

Upon arrival, you will be asked for two deposits (cash or cheque): one €300 deposit for the rental and furnishings, and another deposit for the cleaning fee of the chosen rental (Nature range: €60, Confort range: €80, Prestige range: €100). These two deposits will be reimbursed independently of each other, after a stocktaking and inspection of the site's cleanliness. Each of you will be provided with an access wristband **(the wearing of which is mandatory)** for which you will be charged €5 in the event of it being lost. Off-season: you may arrive on the day of your choice for a stay of minimum 2 nights. You may collect the keys between 4pm and 7pm. In July-August: you must arrive on Saturday or Sunday, according to the conditions of your booking contract, for a stay of at least a week. You may collect the keys between 4pm and 8pm. You must inform the campground in the event of any late arrival. The rental is reserved for 24 hours following the planned date of your arrival. After that time, it will no longer be reserved and you will be required to pay the total cost of your stay. There is an inventory of all the contents of each rental. The tenant is required to carry out an inspection upon arrival, and to signal any possible abnormalities before midday the following day. One vehicle per rental.

### 3- During your Stay

Insurance is the camper's responsibility. Camping de la Plage will in no way be held responsible in the event of the loss, theft or damage of personal items, or damage as the result of a fire, bad weather, etc. Each person staying at the campground is committed to complying with the regulations presented at the entrance to the campground. **There must be total silence between midnight and 7am.** Furthermore, vehicles have a speed limit of 10 km/h, and there is to be no driving between 11pm and 7am. Visitors are allowed on the site from 9am to 11pm. They are obliged to present themselves at reception in order to state their identity and that of the people they are visiting, and to pay a fee. Their vehicle must remain parked in the external car park. Tents are not permitted on rental accommodation sites. The use of barbecues is strictly prohibited outside the areas reserved for this purpose. Over the course of your stay, you may be photographed or filmed to appear in our next advertising material. Should you not agree to this, please notify us with a registered letter, accompanied by a copy of your proof of ID. Pets are allowed on

the site provided the owner pays an additional fee (see rates). **They must be kept on a leash, tattooed, vaccinated (please present vaccination records at reception) and declared at reception.**

In no case may they be left alone at the rental property or campsite. **1st and 2nd category dogs are strictly prohibited.** (cf Ministerial Decrees of 30/06/92, 22/01/85 and 06/01/99)

### 4- Campsite Departures

The campsite must be vacated on the date of departure before 12pm. After this time, you will be charged for an extra night.

### 5- Rental Departures

Departure is to take place on the date indicated on the booking confirmation between 7am and 10am, according to availabilities and by fixed appointment at reception. For any departure made outside the times appointed by reception, €80 will be charged. The accommodation must be returned in a state of perfect cleanliness, and you will be charged for any damage or breakages, as well as for any restoration of the site, if deemed necessary. Retention of the security deposit does not exclude the possibility of an additional payment of damages being charged in the event of the costs being superior to the sum of the deposit.

### 6- Storage - Occupation:

**Unoccupied units can be left on the site only with the management's prior consent and only on the pitch indicated.** This service comes at an extra fee, indicated below. Any pitch that is being used to store a unit, without having signed a rental contract, or if this use is in breach of a contract, notably with regards scheduled payments, a "storage" fee of €40 per day shall be applied for standard pitches, and €60 per day for pitches equipped with water, electricity and waste disposal.

## IV/ CANCELLATION

### 1- Unused Services

**In the event of a late arrival or early departure, no reimbursement will be made.**

**2- Cancellation by the Client** (excluding applications to a specific insurance contract). If the cancellation occurs 45 days or more before the planned date of arrival, the deposit and booking fee will be kept by the campground. If the cancellation occurs less than 45 days before the arrival date, the total cost of the stay will be kept.

### 3- Cancellation by campsite

The Campsite reserves the right to cancel your stay in the case of force majeure or unforeseen circumstances that could pose a health and safety risk.

### Complaints

Any client wishing to make a complaint should contact the campsite complaint service:

- by post with confirmation of receipt to the campsite address. The campsite will reply to the client within two months. When no amicable solution can be found, and if the issue persists, without prejudice to take legal action, the Campsite will offer to call a mediator: SAS Médiation Solution  
222, chemin de la bergerie - 01800 Saint Jean de Niost -  
contact@sasmediationsolution-conso.fr -  
<https://sasmediationsolution-conso.fr/>

### Right of withdrawal

In accordance with article L.121-19 of the consumer code, the Campsite informs its clients that the sale of accommodation services provided on a specific date, or during a defined period, is not subject to a 14-day withdrawal period.

### 4. Campez-Couvert Cancellation and Interruption Insurance:

Our partner Gritchen Affinity offers an insurance for the cancellation or interruption of your stay, optional with your rental contract, that allows only those clients who have signed up for Campez Couvert insurance to be reimbursed for all or part of their stay.

In the case of cancellation, please notify the campground of your withdrawal, by post or email, as soon as the event occurs that prevents your departure. If the incident is covered in the general conditions (available at [www.campez-couvert.com](http://www.campez-couvert.com) or from the campground), please notify the insurer within 48 hrs, and provide all the necessary information and substantiating documents.

## V/ DATA PROTECTION

The information you provide us with when making your reservation will not be passed on to any third party. This information will be considered confidential. It will only be used by internal services for dealing with your request and for strengthening and personalising the communication and services offered to Camping Grand Sud customers in accordance with your interests. In accordance with the European Data Protection Regulation, you have the right to access, rectify and object to personal data concerning you. To do so, simply send us a request by post to the following address, and include your surname, first name and address: Camping La Plage Boulevard de l'Atlantique - 40200 MIMIZAN PLAGE.

# Contract of reservation 2022

Family name ..... First name .....  
 Address .....  
 Postcode ..... City .....  
 Country ..... Date of Birth .....  
 Phone ..... Mobile .....  
 E-mail .....  
 Vehicle, registration n° .....

**• Holiday Participants. Maximum 6 people depending on the chosen accommodation, or 6 people per campsite (babies included)**

| Family name | First Name | Date of Birth |
|-------------|------------|---------------|
|             |            |               |
|             |            |               |
|             |            |               |
|             |            |               |
|             |            |               |
|             |            |               |
|             |            |               |
|             |            |               |

## Rental

From ..... to .....

- Ti Lodge 1 bed.    
  Mobil home 2 bed.    
  Cottage Comfort 2 bed.    
  Chalet Comfort Plus 2 bed.    
  Cottage Prestige 3 bed.  
 Lodge 2 bed.    
 disabled access    
  Cottage Comfort 3 bed.  
 Safari Lodge 2 bed.    
  Mobil home Comfort 3 bed.

## EXTRAS

- Pet (cf campsite rates) ..... € x ..... nights = ..... €
- Cleaning fee:  Nature Range : 60 €  Confort Range : 80 €  Prestige Range : 100 € ..... €
- Baby kit (travel cot, baby bath and highchair): 5 € x ..... days = ..... €

## Pitch

From ..... to .....

- Tent    
  Caravan    
  Camper van    
  Fitted van • Size of your equipment **OBLIGATORY**: ..... m x ..... m

## EXTRAS (cf. campsite rates)

- Extra tent ..... tent(s) x ..... € x ..... nights = ..... €
- Fridge (subject to availability) ..... € x ..... nights = ..... €

## Cost of the Stay

- Total cost of the stay: ..... €
- I wish to sign up for insurance  Total cost of the stay (excluding administrative fee) x 2.9% ..... €
- Administrative fee  Week: ..... 20 €
- Weekend : ..... 10 €

Report of total rental or campsite EXTRAS ..... €

• **TOTAL COST OF YOUR STAY:** ..... €

• Deposit\*: ..... €

\* If the reservation for Camping La Plage takes place more than 30 days before the date of the stay, a deposit of 30% of the total cost of the stay + an administrative fee will be required, and the remaining balance must be paid 30 days before the starting date of your stay, at the latest. \* If the reservation for Camping La Plage takes place less than 30 days before the start of your stay, you must pay the total cost of your stay upon reservation. **Complaints.** Any client wishing to make a complaint should contact the campsite complaint service: - by post with confirmation of receipt to the campsite address. The campsite will reply to the client within two months. When no amicable solution can be found, and if the issue persists, without prejudice to take legal action, the Campsite will offer to call a mediator: SAS Médiation Solution 222, chemin de la bergerie - 01800 Saint Jean de Niost - contact@sasmediationsolution-conso.fr - <https://sasmediationsolution-conso.fr/>

## Payment method (upon reservation)



- Bank transfer: Banque BPACA - IBAN FR76 1090 7001 1996 0216 3679 206 - BIC : CCBPFRPPBDX (Option to stagger the transfers via our website or by post.)

I declare that I have read and understood the General Conditions of

Sale set out above and that I accept them without reservation.

I agree that the information entered into this form will be handled in the context of the rental and the resulting business relationship.

Place ..... Date .....

Signature required:

# La Plage

## Camping - Club



Info and bookings: [www.destinationmimizan.com](http://www.destinationmimizan.com) - Tel : +33 (0)5 58 09 00 32



### ACCESS



Bordeaux-Mérignac Airport (120 km) - Biarritz-Parme Airport (120 km)  
Pau-Pyrénées Airport (150 km)



LABOUHEYRE train station (27 km) - BORDEAUX - ST JEAN train station (120 km)



GPS : Latitude : 44.216486 | Longitude : -1.285754

From Bordeaux (120 km) : A 63 - exit 16 Labouheyre - D626

From Toulouse (245 km): A 62 - exit 6 Damazan - D8 - D 933 - D 626

From Bayonne (111 km): A 63 - exit 15 Escource - Sabres Cap de Pin - D 44

From Agen (180 km): A 62 - exit 6 Damazan - D8 - D 933 - D 626

From Auch (180 km): D 124 - D 6 - D30 - N 134 to Sabres - D44

ASP EDITION WEB - Tél. 05 59 03 35 62 - Graphiste: Benoît Bernardin

## OUR PARTNER DESTINATIONS

CAMPINGS  
GRAND SUD  
[www.campingsgrandsud.fr](http://www.campingsgrandsud.fr)

Sunélia  
LES EMBRUNS  
★★★★  
LÈGE CAP-FERRET - GIRONDE  
[www.camping-lesebruns.fr](http://www.camping-lesebruns.fr)

Le Pipiou  
Camping - Club  
★★★★  
PARENTIS - LANDES  
[www.camping-pipiou.fr](http://www.camping-pipiou.fr)

La Pointe  
Camping - Club  
★★★★  
CAPBRETON - LANDES  
[www.camping-lapointe.com](http://www.camping-lapointe.com)

Le Lac  
Camping - Club  
★★★  
MIMIZAN - LANDES  
[www.destinationmimizan.com](http://www.destinationmimizan.com)

Sunélia  
LES OLYATS  
★★★★  
SEIGNOSSE - LANDES  
[www.campinglesolyats.fr](http://www.campinglesolyats.fr)

Le Marisol  
Camping - Club  
★★★★  
TORREILLES - PYRÉNÉES ORIENTALES  
[www.camping-marisol.fr](http://www.camping-marisol.fr)

Lac du Salagou  
Camping - Club  
★★★★  
CLERMONT L'HERAULT - HERAULT  
[www.campinglacdusalagou.fr](http://www.campinglacdusalagou.fr)

### Camping Club La Plage ★★★★★

Boulevard de l'Atlantique - 40200 MIMIZAN PLAGE - Tél : +33 (0)5 58 09 00 32

[contactplage@destinationmimizan.com](mailto:contactplage@destinationmimizan.com) - [www.destinationmimizan.com](http://www.destinationmimizan.com) -